

LANDMARK

AT WATERFRONT



The master bedroom retreat is completed by two oversized walk-in closets. Along with expansive space throughout the home, a large laundry room maintains organization of everyday routines.



Residence 102

3 BEDROOM + 3.5 BATH

INTERIOR: 2,567 SF

EXTERIOR: 786 SF

~ BOW RIVER ~

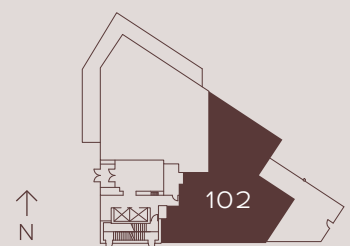

Level 1

The developer reserves the right to make changes and modifications to the information contained herein. Floorplans and floorplates are subject to change without notice. Please contact a developer sales representative for details. The developer may also make such further development modifications as are permitted by the disclosure statement, as may be amended, the contract of purchase and sale between a purchaser and developer (if applicable), or otherwise. E. & O.E.