

LANDMARK

AT WATERFRONT

128

Entertain with pleasure and pride from an open-concept living space that seamlessly reveals an elongated terrace. A corner master suite is large enough for sitting furniture and features stunning views across the river.



Plan B4

2 BEDROOM + 2.5 BATH

INTERIOR: 2,188 SF

EXTERIOR: 569 SF

~ ~ ~ BOW RIVER ~ ~ ~

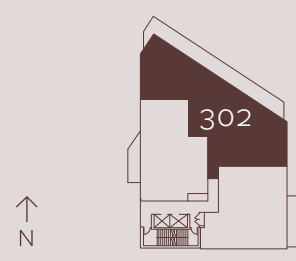

Level 3

The developer reserves the right to make changes and modifications to the information contained herein. Floorplans and floorplates are subject to change without notice. Please contact a developer sales representative for details. The developer may also make such further development modifications as are permitted by the disclosure statement, as may be amended, the contract of purchase and sale between a purchaser and developer (if applicable), or otherwise. E. & O.E.