

# LANDMARK

AT WATERFRONT

128

A large open-concept living space welcomes you home, along with views of the flowing Bow River from the front windows. Another scene awaits from your deck, where you can observe the nature in Sien Lok Park.



## Plan A

2 BEDROOM + 2 BATH

INTERIOR: 1,249 SF

EXTERIOR: 112 SF

~ BOW RIVER ~

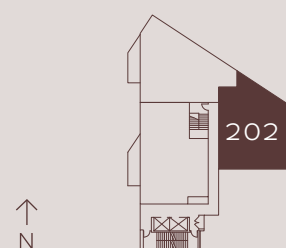

Level 2

The developer reserves the right to make changes and modifications to the information contained herein. Floorplans and floorplates are subject to change without notice. Please contact a developer sales representative for details. The developer may also make such further development modifications as are permitted by the disclosure statement, as may be amended, the contract of purchase and sale between a purchaser and developer (if applicable), or otherwise. E. & O.E.